

Main Feature

1. One-piece forged body
2. COP series with two sides short nipple (60-100mm) is forged with valve body together
3. Seat: body+STL, Disc: Gr.660+STL
4. Standard inner diameter size: 11mm, 14mm, 18mm
5. Stem threads are hardened to prevent biting
6. Grease for stem threads is isolated from the system medium
7. The non-rotating lower stem moves up and down, reducing packing friction with each stroke and biting between the seat and the head
8. The externally adjusted gland is not constrained by stem threads
9. Each valve is sealed with nitrogen or compressed air at rated working pressure before delivery.
10. Design standard is accordance with ASME B 16.34, API 602, ASME B16.11, ASME B16.25
11. Test standard is accordance with API598

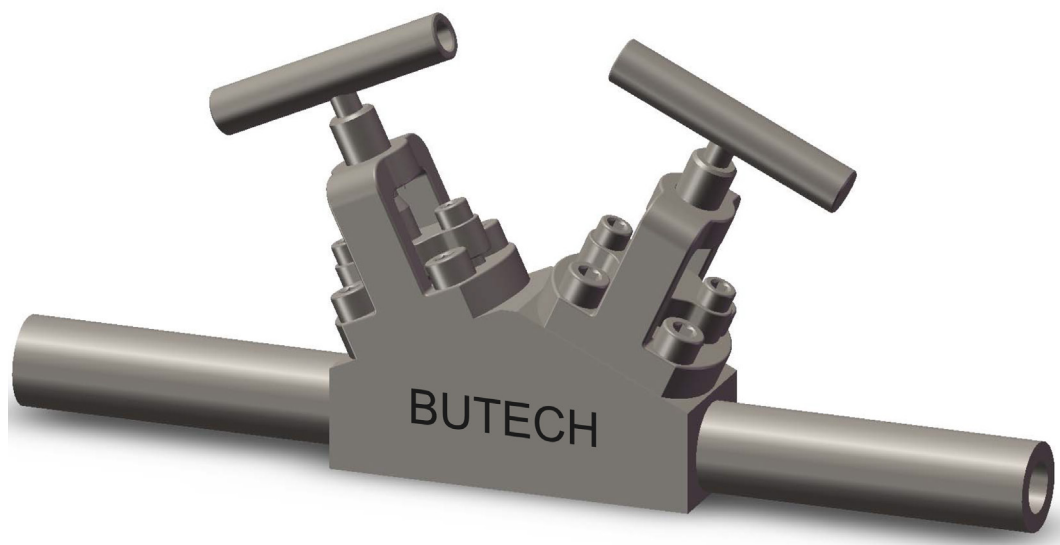

All dimensions are for reference only and are subject to change.
Dimensions in parentheses are millimeters (mm)
All equipment manufactured in U.S.A

Page 1

BuTech
an Accudyne Industries brand

Printed in USA

100 East Graham Place • Burbank, CA 91502 USA • Ph: (814) 833-4904 • Fax: (814) 833-2612 • E-mail: hq@butech-va.com

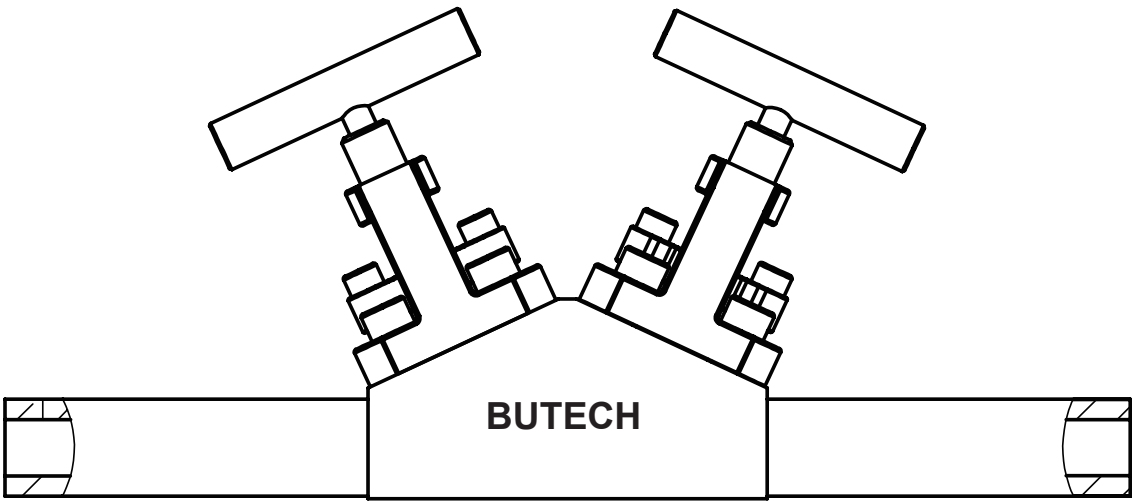

ITEM	DESCRIPTION	MATERIAL		
		STD Temperature	HIGH Temperature	Stainless Steel
1	BODY	ASTM A105	ASTM A182-F11/F22/F91/F92	ASTM A182-F316/F321/F347
2	BONNET	ASTM A105	ASTM A182-F11/F22/F91/F92	ASTM A182-F316/F321/F347
3	DISC	Gr.660+STL	Gr.660+STL	Gr.660+STL
4	SEAT	ASTM A105+STL	ASTM A182-F11/F22/F91/F92+STL	ASTM A182-F316/F321/F347+STL
5	STEM BOLTS	ASTM A276-420	ASTM A276-420	ASTM A276-420
6	STEM	ASTM A276-F6a	ASTM A276-F6a	ASTM A276-F6a
7	GASKET	304SS/316L	304SS/316L	304SS/316L
8	HANDWHEEL	A197	A197	A197
9	PACKING	GRAPHITE	GRAPHITE	GRAPHITE
10	BOLTS	ASTM A193-B7	ASTM A193-B16	ASTM A193-B8

Note:Butech can customize materials and body lengths to meet customer requirements



All dimensions are for reference only and are subject to change.
Dimensions in parentheses are millimeters (mm)
All equipment manufactured in U.S.A



Printed in USA

Main Feature

1. One-piece forged body
2. CO series with two sides short nipple (60-100mm) is forged with valve body together
3. Seat: body+STL, Disc: Gr.660+STL
4. Standard inner diameter size: 11mm, 14mm, 18mm
5. Stem threads are hardened to prevent biting
6. Grease for stem threads is isolated from the system medium
7. The non-rotating lower stem moves up and down, reducing packing friction with each stroke and biting between the seat and the head
8. The externally adjusted gland is not constrained by stem threads
9. Each valve is sealed with nitrogen or compressed air at rated working pressure before delivery.
10. Design standard is accordance with ASME B 16.34, API 602, ASME B16.11, ASME B16.25
11. Test standard is accordance with API598

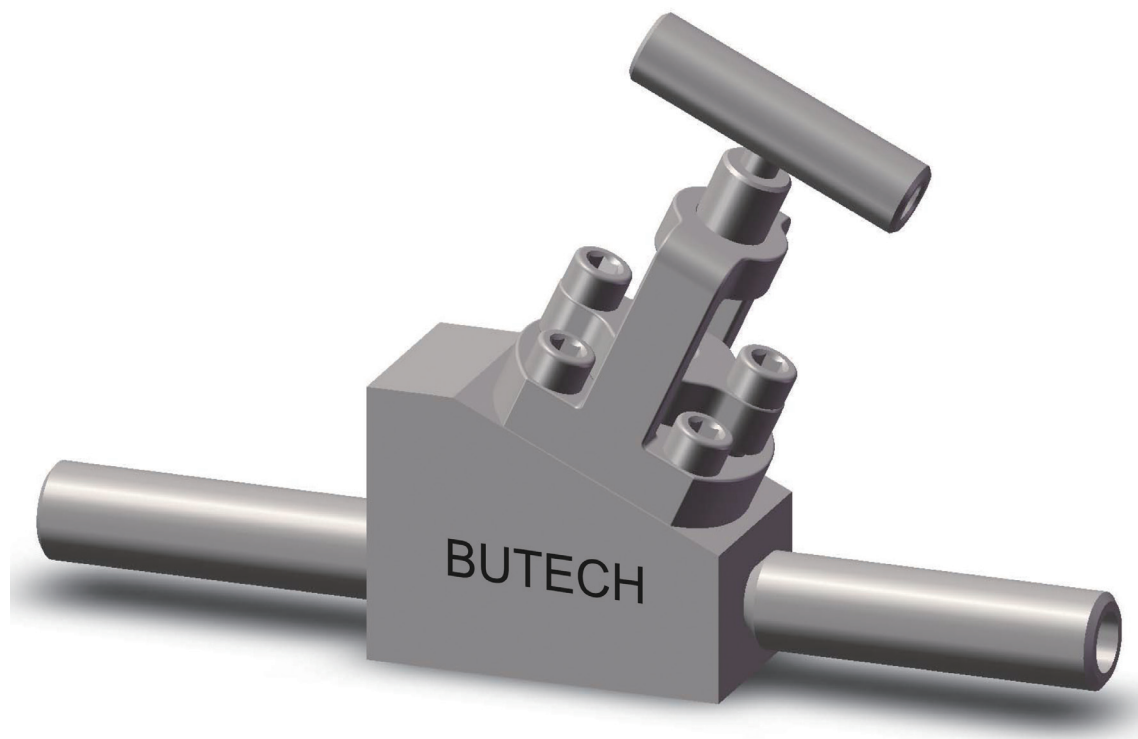

All dimensions are for reference only and are subject to change.
Dimensions in parentheses are millimeters (mm)
All equipment manufactured in U.S.A

Page3

BuTech
an Accudyne Industries brand

Printed in USA

100 East Graham Place • Burbank, CA 91502 USA • Ph: (814) 833-4904 • Fax: (814) 833-2612 • E-mail: hq@butech-va.com

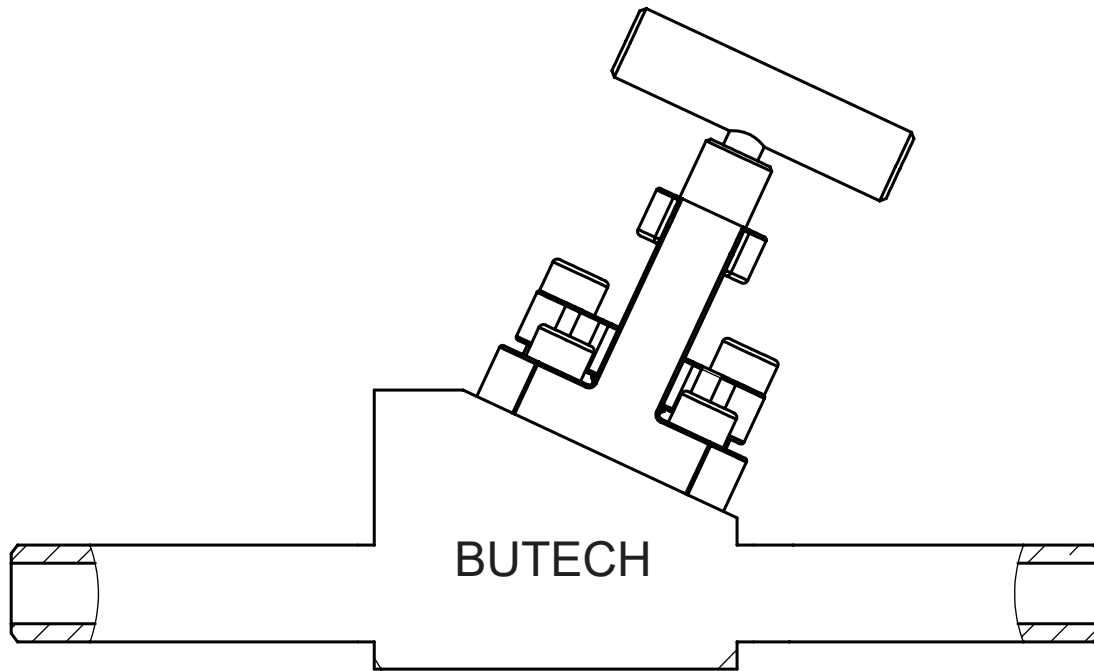

ITEM	DESCRIPTION	MATERIAL		
		STD Temperature	HIGH Temperature	Stainless Steel
1	BODY	ASTM A105	ASTM A182-F11/F22/F91/F92	ASTM A182-F316/F321/F347
2	BONNET	ASTM A105	ASTM A182-F11/F22/F91/F92	ASTM A182-F316/F321/F347
3	DISC	Gr.660+STL	Gr.660+STL	Gr.660+STL
4	SEAT	ASTM A105+STL	ASTM A182-F11/F22/F91/F92+STL	ASTM A182-F316/F321/F347+STL
5	STEM BOLTS	ASTM A276-420	ASTM A276-420	ASTM A276-420
6	STEM	ASTM A276-F6a	ASTM A276-F6a	ASTM A276-F6a
7	GASKET	304SS/316L	304SS/316L	304SS/316L
8	HANDWHEEL	A197	A197	A197
9	PACKING	GRAPHITE	GRAPHITE	GRAPHITE
10	BOLTS	ASTM A193-B7	ASTM A193-B16	ASTM A193-B8

Note:Butech can customize materials and body lengths to meet customer requirements



All dimensions are for reference only and are subject to change.
 Dimensions in parentheses are millimeters (mm)
 All equipment manufactured in U.S.A

AE/CE Series - Needle Valves

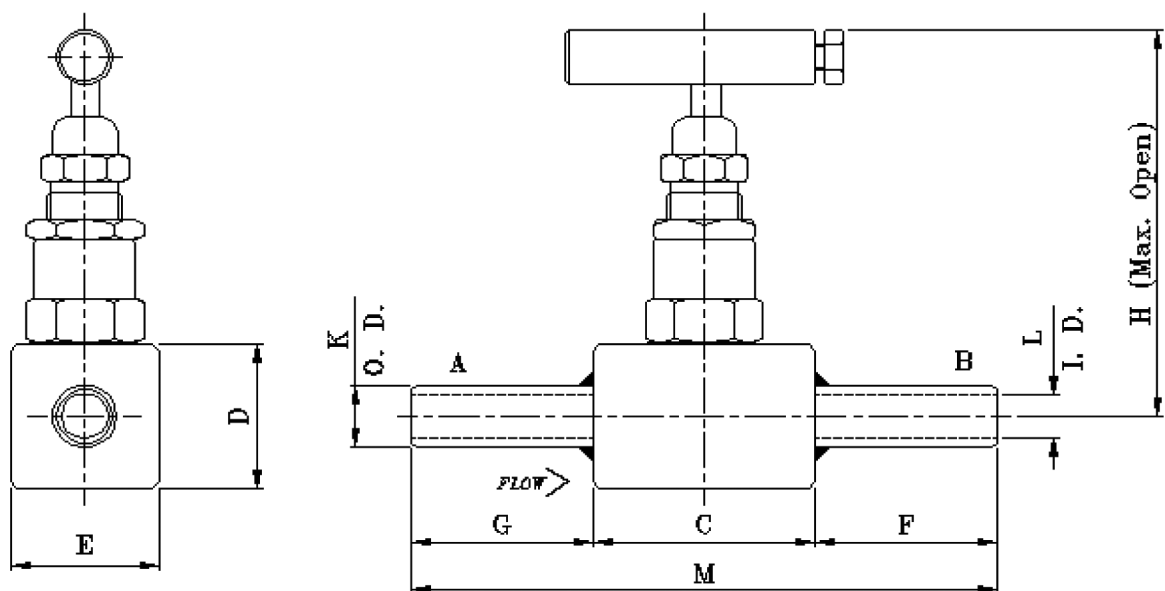

Standard: ANSI B16.34

Working Pressure: 483 Bar @ 25°C
246 Bar @ 648°C

Temperature Rating: 232°C with PTFE packing
648°C with Graphite packing with (-H option)

Model	Inlet x Outlet			Dimensions (mm)									Orifice (mm)	Cv
	Size 'A'	Size 'B'	Connection	C	D	E	F	G	H	K	L	M		
AE-12M-B	12mm	12mm	Tube Weld	76.0	32.0	32.0	100.0	100.0	92.0	12.0	8.0	276.0	6.0	0.7
AE-14M-B	14mm	14mm		76.0	32.0	32.0	100.0	100.0	92.0	14.0	10.0	276.0	6.0	0.7
AE-16M-B	16mm	16mm		76.0	32.0	32.0	100.0	100.0	92.0	16.0	10.0	276.0	6.0	0.7
CE-12M-B	12mm	12mm		89.0	49.0	49.0	100.0	100.0	110.0	12.0	8.0	289.0	11.0	2.5
CE-14M-B	14mm	14mm		89.0	49.0	49.0	100.0	100.0	110.0	14.0	10.0	289.0	11.0	2.5
CE-16M-B	16mm	16mm		89.0	49.0	49.0	100.0	100.0	110.0	16.0	10.0	289.0	11.0	2.5
CE-18M-B	18mm	18mm		89.0	49.0	49.0	100.0	100.0	110.0	18.0	12.0	289.0	11.0	2.5
CE-22M-B	22mm	22mm		89.0	49.0	49.0	100.0	100.0	110.0	22.0	16.0	289.0	11.0	2.5
CE-25M-B	25mm	25mm	Pipe Weld	89.0	49.0	49.0	100.0	100.0	110.0	25.0	17.0	289.0	11.0	2.5
CE-8-B	1/2"	1/2"		89.0	49.0	49.0	100.0	100.0	110.0			289.0	11.0	2.5
CE-12-B	3/4"	3/4"		89.0	49.0	49.0	100.0	100.0	110.0			289.0	11.0	2.5

For other connections and sizes, contact factory or local distributor

**ISO 9001
CERTIFIED**

All dimensions are for reference only and are subject to change.
Dimensions in parentheses are millimeters (mm)
All equipment manufactured in U.S.A

BuTech
an Accudyne Industries brand

AM/CM Series - Double Needle Valves

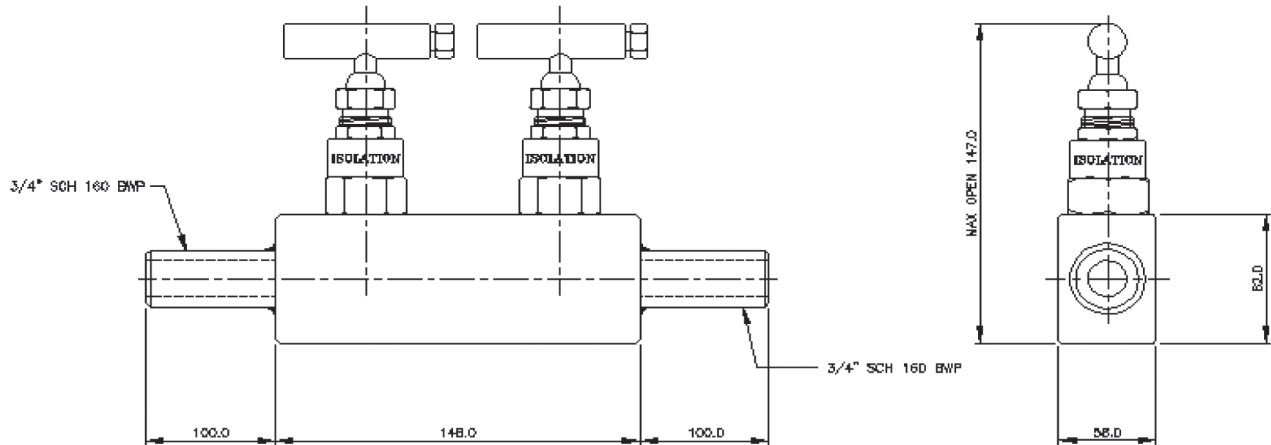

Standard: ANSI B16.34, Class 2500

Working Pressure: **483 Bar @ 25°C**
 246 Bar @ 648°C

Temperature Rating: **232°C with PTFE packing**
 648°C with Graphite packing with (-H option)

Model	Inlet x Outlet		Orifice (mm)
	Size	Connection	
AMT-12M-B-321	12mm	Butt Weld Pipe	6.0
AMT-14M-B-321	14mm		6.0
AMP-8-B-321	1/2"		6.0
AMP-12-B-321	3/4"		6.0
CMT-16M-B-321	16mm		11.0
CMT-18M-B-321	18mm		11.0
CMT-25M-B-321	25mm		11.0
CMP-8-B-321	1/2"		11.0
CMP-12-B-321	3/4"		11.0
CMP-16-B-321	1"		11.0

Note: 1)

A M ☐



"T" means butt-weld tube
"P" means butt-weld pipe

2) To specify the length of the long pipe or tube, please add a number plus "M" at the end of Model No., for example CMP-12-B-321-H-100M means double needle valve with 100mm long pipe.

For other connections, sizes and materials, contact factory or local distributor



All dimensions are for reference only and are subject to change.
 Dimensions in parentheses are millimeters (mm)
 All equipment manufactured in U.S.A

